

Greenplate Equal Access Double Electric BBQ System



Key Features:

- Registered Design Patent #: 2014101175
- DDA Compliant
- Blue & White LED Push Button Lighting
- Fully Conforming High Visibility Signage
- Wheelchair Access on all sides
- Audible On/ Off Tones
- 316 Stainless-Steel Substructure & Bench Top

Dimensions:

Length: 2400mm Height: 870mm

Width: 1220mm Weight: 180kg*

Weight excluding BBQ. Add 42kg per BBQ.

Warranty:

Electrical Components: 2 Years

Heating Element: 5 Years

All Stainless-Steel Components: *Lifetime**

**Includes BBQ, Substructure and Bench Top.
Conditions Apply.*

Electrical Information:

Power Supply: 200/230VAC | 50/60Hz
Self-Selecting

ESO Approval #: SAA172029

Element: 1800Watts 7.8amps

Patent #: 761137

Conformant to AS/NZ 60335.1-2011 + A1
Standards for General Electrical Appliance Safety

*All Electrical work must be carried out by
appropriate Electrical Licensed Personnel.*

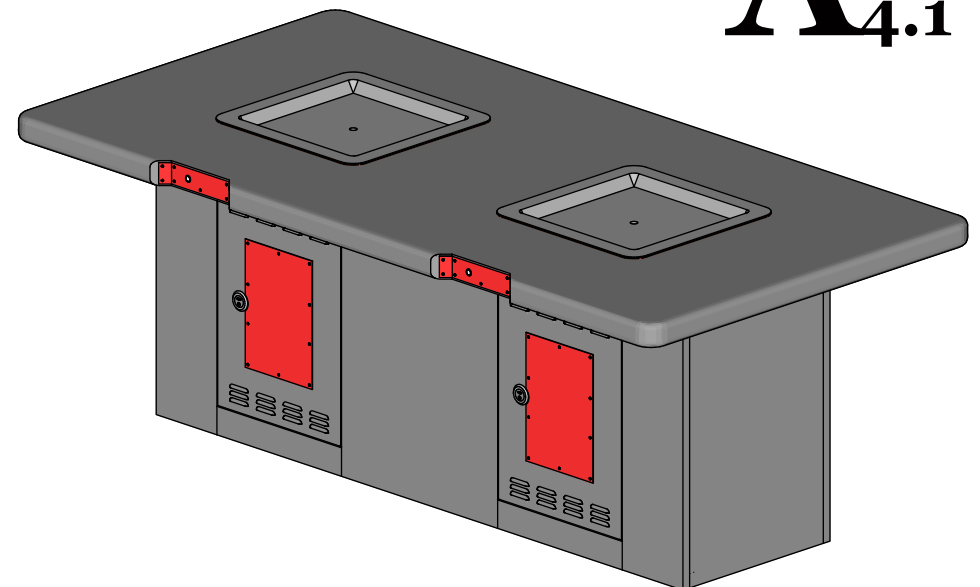
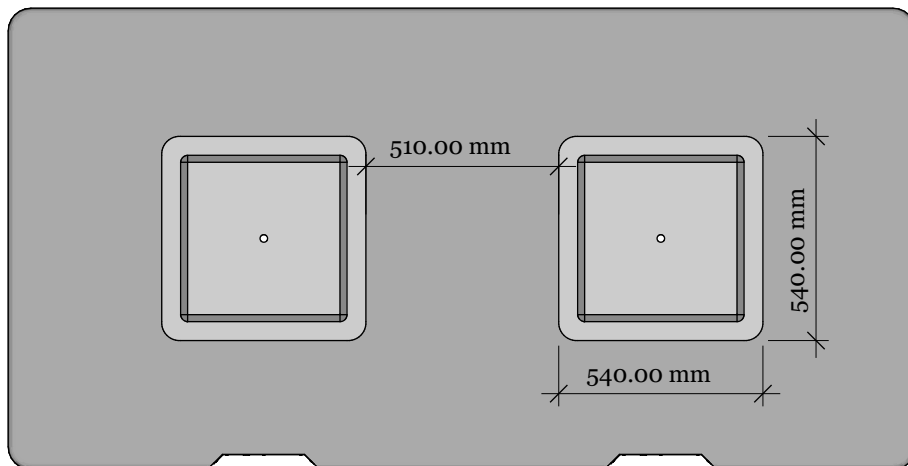
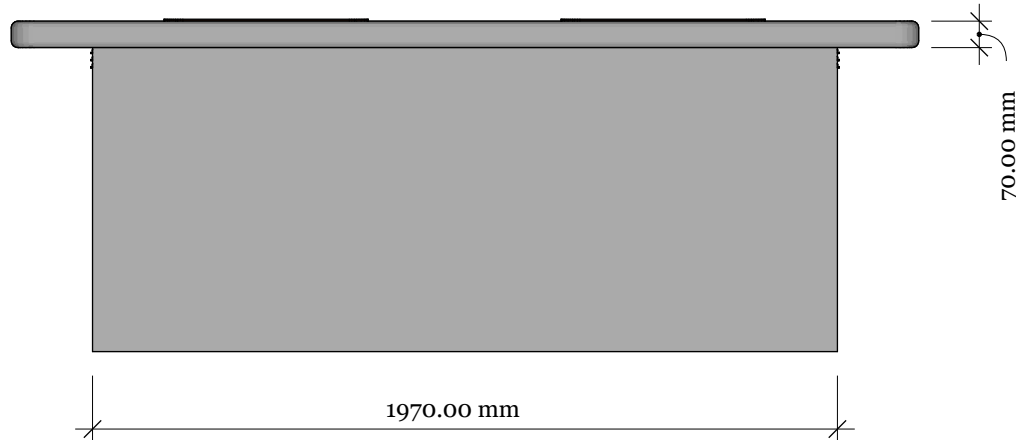
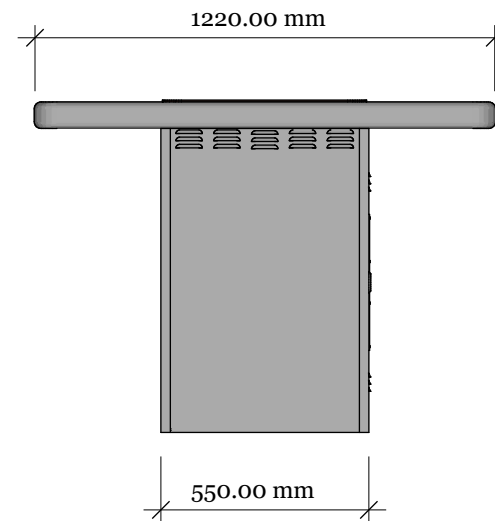
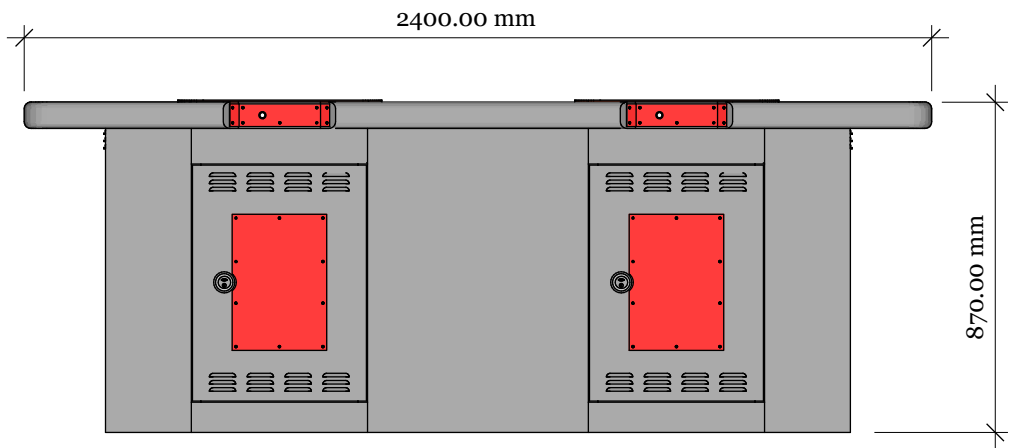

COMPANY NAME
Greenplate PTY LTD
Unit 2/15 Natasha Street,
Capalaba 4157, Queensland,
Australia

PROJECT
Greenplate Equal Access Double
Stand Alone Unit

DRAWN BY
EK

ISSUE
28.01.20

DRAWING NO.
010 - SD S

DESCRIPTION
1:20 (1mm:20mm @ A4)

A_{4.1}